

# What's new in Windows 10 1803

Stefan Schörling  
Lumagate part of Innofactor

# Windows 10 Versions

Version	Code Name	Initial Build	Channel Switch	Current Channel	Release	Channel Switch	End of Support	Extended Support	.NET Runtime	Powershell
1507	Threshold	10240.16405	N/A	CBB	29.07.2015	N/A	09.05.2017	N/A	4.6	5.0
1511	Threshold 2	10586.3	10586.164	CBB	10.11.2015	08.03.2016	10.04.2018	N/A	4.6.1	5.1
1607	Redstone	14393.10	14393.447	CBB	02.08.2016	08.11.2016	09.10.2018	charged	4.6.2	5.1
1703	Redstone 2	15063.138	15063.483	SAC	05.04.2017	11.07.2017	09.04.2019	charged	4.7	5.1
1709	Redstone 3	16299.19	16299.125	SAC	17.10.2017	12.12.2017	08.10.2019	charged	4.7.1	5.1
1803	Redstone 4	17134.1	N/A	SAC-T	30.04.2018	N/A	October 2019	N/A	4.7.2	5.1
1809	Redstone 5	N/A	N/A	Preview	N/A	N/A	N/A	N/A	N/A	N/A
1507 LTSB	Threshold	10240.16405	N/A	LTSB	29.07.2015	N/A	13.10.2020	14.10.2025	4.6	5.0
1607 LTSB	Redstone	14393.10	N/A	LTSB	02.08.2016	N/A	12.10.2021	13.10.2026	4.6.2	5.1
1809 LTSC	Redstone 5	N/A	N/A	N/A	Fall 2018	N/A	N/A	N/A	N/A	N/A

<https://blogs.msdn.microsoft.com/hewagen/win10ver/>

# Deprecated Features

<https://docs.microsoft.com/en-us/windows/deployment/planning/windows-10-1803-removed-features>

# 1803 Update – Privacy Screen...ssss

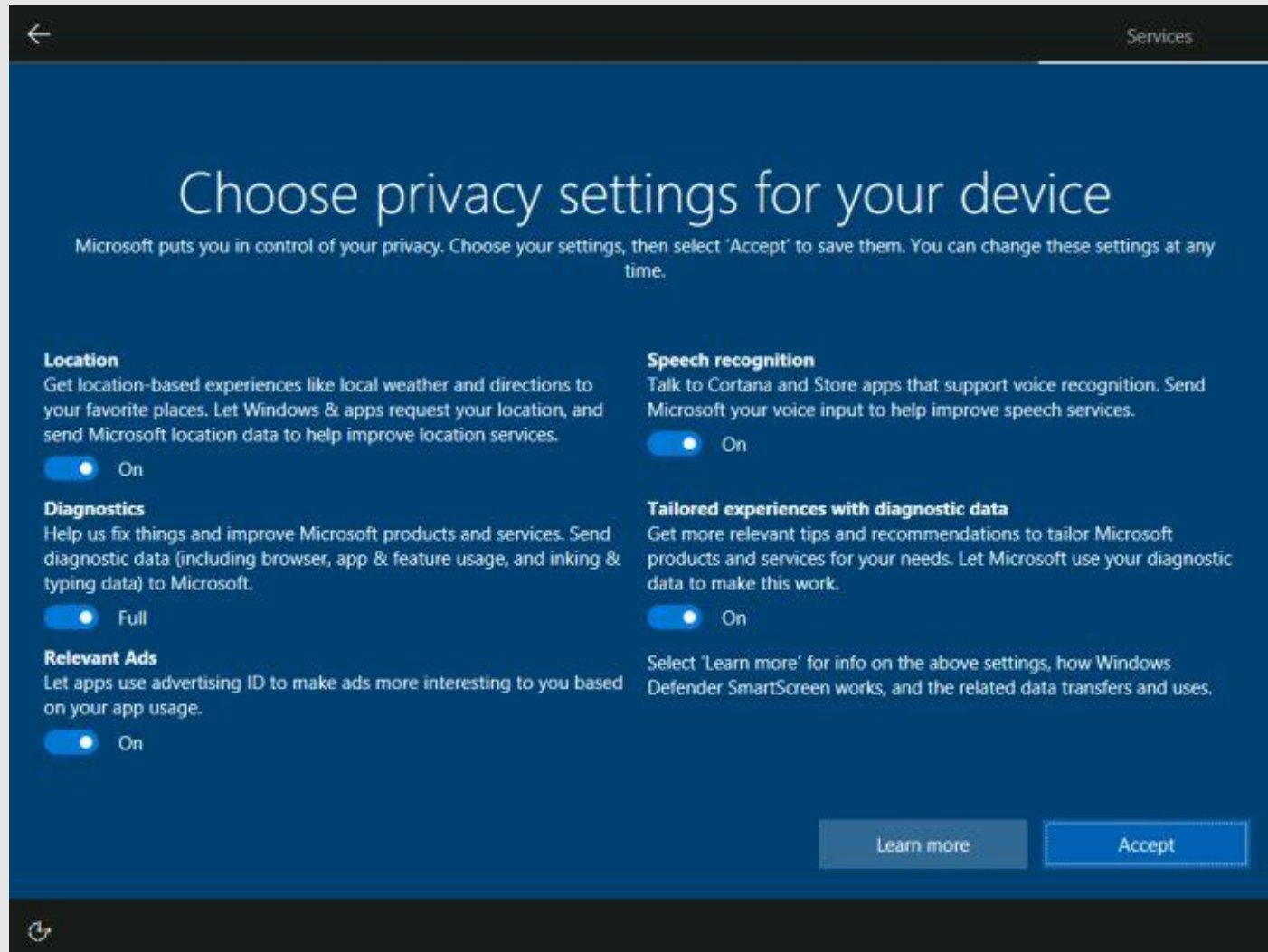

# Do more with your voice

Choose your settings, then select 'Accept' to save them. Check the 'Learn more' link for info on these settings, how to change them, how Windows Defender SmartScreen works, and the related data transfers and uses.



## Use speech recognition

Talk to Cortana and other apps that support cloud-based voice recognition. Send Microsoft your voice input to help improve our speech services.



## Don't use speech recognition

You won't be able to talk to Cortana and other voice-enabled Microsoft Store apps.

Learn more

Accept





# Let Microsoft use your location

Choose your settings, then select 'Accept' to save them. Check the 'Learn more' link for info on these settings, how to change them, how Windows Defender SmartScreen works, and the related data transfers and uses.



**Yes**

Get location-based experiences like directions and weather. Let Windows & apps request your location. Microsoft will use location data to improve our location services.



**No**

You won't be able to get directions based on your current location automatically or enjoy other services that need your location to work.

Learn more

Accept





## Find my device

Choose your settings, then select 'Accept' to save them. Check the 'Learn more' link for info on these settings, how to change them, how Windows Defender SmartScreen works, and the related data transfers and uses.



**Yes**

Turn on Find my device (requires Microsoft account) and use your device's location data to help you find your device if you lose it.



**No**

Windows won't be able to help you keep track of your device if you lose it.

Learn more

Accept



# Send diagnostic data to Microsoft

Choose your settings, then select 'Accept' to save them. Check the 'Learn more' link for info on these settings, how to change them, how Windows Defender SmartScreen works, and the related data transfers and uses.



## Full

Send all Basic diagnostic data, along with info about the websites you browse and how you use apps and features, plus additional info about device health, device usage, and enhanced error reporting. Diagnostic data is used to help keep Windows secure and up-to-date, troubleshoot problems, and make product improvements. Regardless of whether you select Basic or Full, your device will be equally secure and will operate normally.



## Basic

Send only info about your device, its settings and capabilities, and whether it is performing properly. Diagnostic data is used to help keep Windows secure and up-to-date, troubleshoot problems, and make product improvements. Regardless of whether you select Basic or Full, your device will be equally secure and will operate normally.

[Learn more](#)[Accept](#)



# Improve inking & typing recognition

Choose your settings, then select 'Accept' to save them. Check the 'Learn more' link for info on these settings, how to change them, how Windows Defender SmartScreen works, and the related data transfers and uses.



**Yes**

Send inking and typing data to Microsoft to improve the language recognition and suggestion capabilities of apps and services running on Windows.



**No**

Don't use my data to help improve the language recognition and suggestion capabilities of apps and services running on Windows.

Learn more

Accept

# Get tailored experiences with diagnostic data

Choose your settings, then select 'Accept' to save them. Check the 'Learn more' link for info on these settings, how to change them, how Windows Defender SmartScreen works, and the related data transfers and uses.



## Yes

Let Microsoft offer you tailored experiences based on the diagnostic data you have chosen (either Basic or Full). Tailored experiences mean personalized tips, ads, and recommendations to enhance Microsoft products and services for your needs.



## No

The tips, ads, and recommendations you see will be more generic and may be less relevant to you.

[Learn more](#)[Accept](#)



# Let apps use advertising ID

Choose your settings, then select 'Accept' to save them. Check the 'Learn more' link for info on these settings, how to change them, how Windows Defender SmartScreen works, and the related data transfers and uses.



**Yes**

Apps can use advertising ID to provide more personalized advertising in accordance with the privacy policy of the app provider.



**No**

The number of ads you see won't change, but they may be less relevant to you.

[Learn more](#)

[Accept](#)



# End User Enhancements

- Timeline
- Nearby sharing
- Focus Assist
- Edge
- Settings
- Windows Hello
- Servicing Changes

# End User Demo

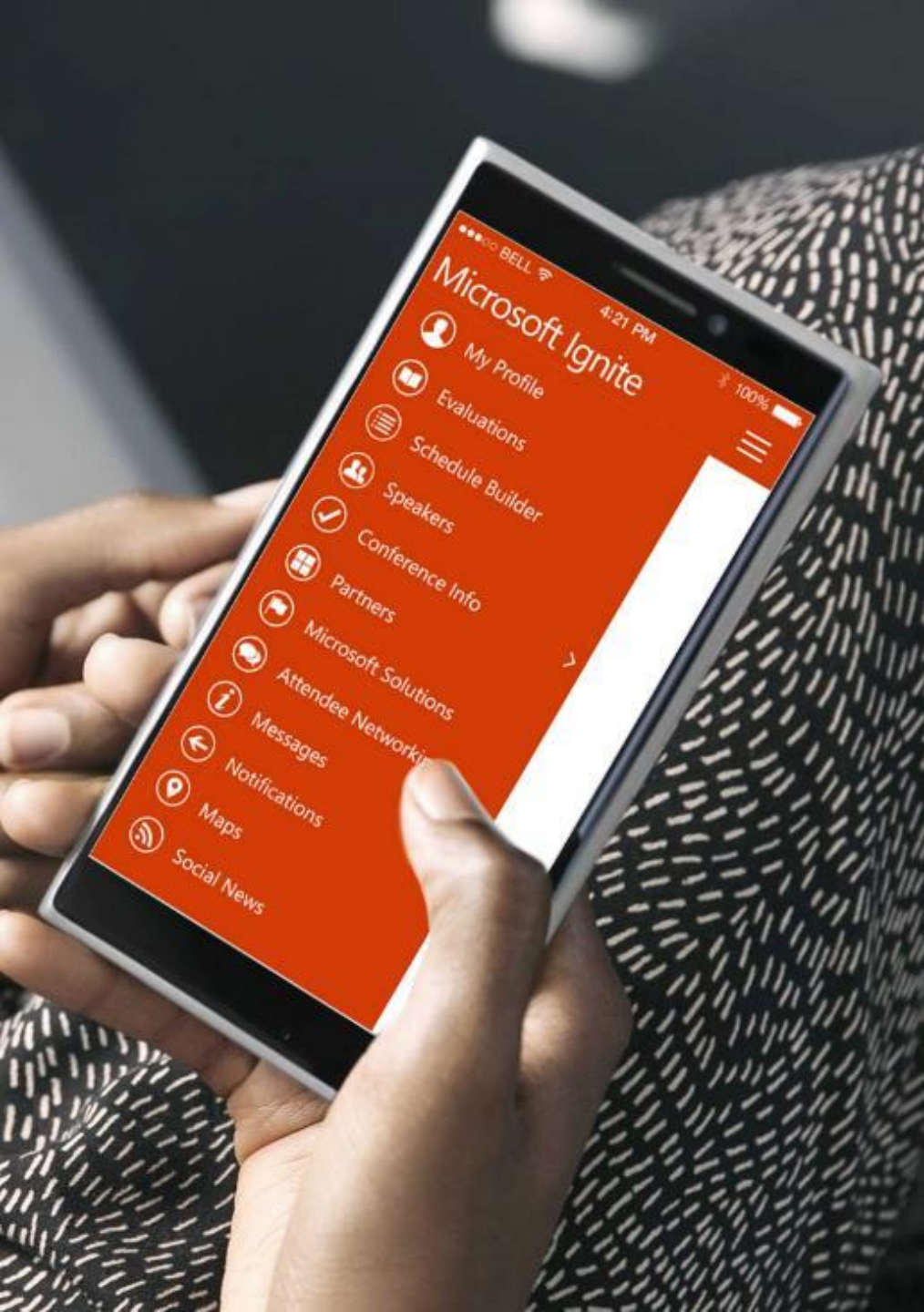

Timeline

Edge

Focus Assist

# IT Pro Features

- More CSPs
- Autopilot Enhancements
- Windows 10 S
- Windows 10 Kiosk
- Analytics Enhancements
- Windows Defender Enhancements
- Privacy Enhancements
- New Security Baseline

# Defender ATP

- Role Based Access
- Microsoft Secure Score
- Automated Investigation of Alerts
- Conditional Access Integration
- New Exploit Protection for Lateral Movement Techniques
- Virtualization Based Security and HVCI for Kernel Based Attacks

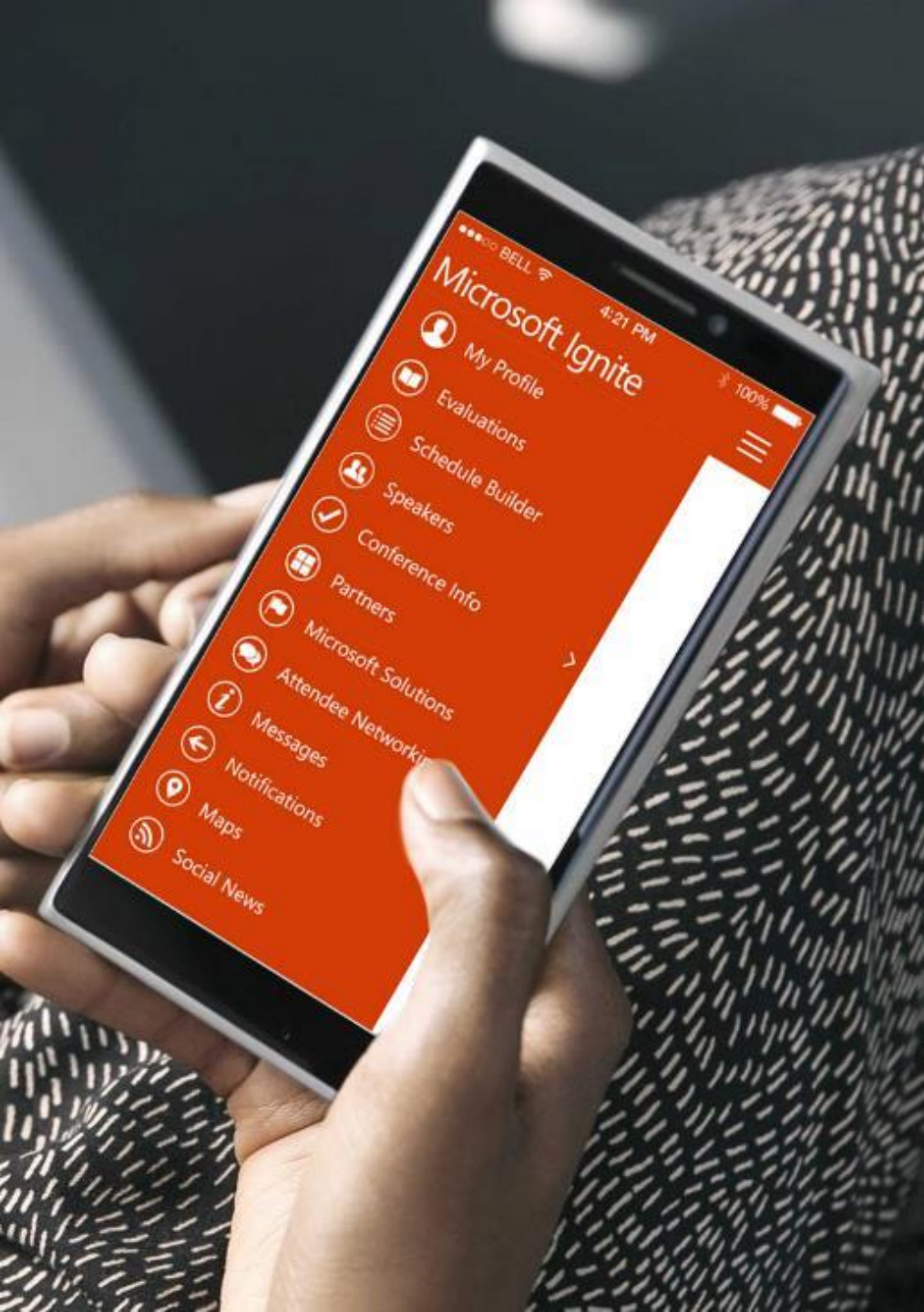

# IT Pro Demo



# Links

## What's new in W10 1803 (Docs)

<https://docs.microsoft.com/en-us/windows/whats-new/whats-new-windows-10-version-1803>

## What's new in W10 April Update

<https://blogs.windows.com/windowsexperience/2018/04/30/whats-new-in-the-windows-10-april-2018-update/>

## What's new for IT Pros

<https://techcommunity.microsoft.com/t5/Windows-IT-Pro-Blog/What-s-new-for-IT-pros-in-Windows-10-version-1803/ba-p/188568>

# CSP

<https://docs.microsoft.com/en-us/windows/client-management/mdm/new-in-windows-mdm-enrollment-management#whatsnew1803>